

Element fenders are fully moulded rubber legs with embedded mounting plates. Fendguard's element type fenders are high performance units which are extremely compact and versatile. These fenders can also be used with a UHMW-PE shield to provide a low cost alternative to an arch type fender. The major characteristics of Fendguard's element type fender include:

- Good energy absorption to reaction force ratio (E/R)
- High energy absorption per weight of rubber
- A narrower footprint than traditional leg fenders which allows for a multitude of configurations
- Can be fixed behind a panel or a pile and can be provided in varying lengths
- Vertically and horizontally mounted elements may be combined in one system

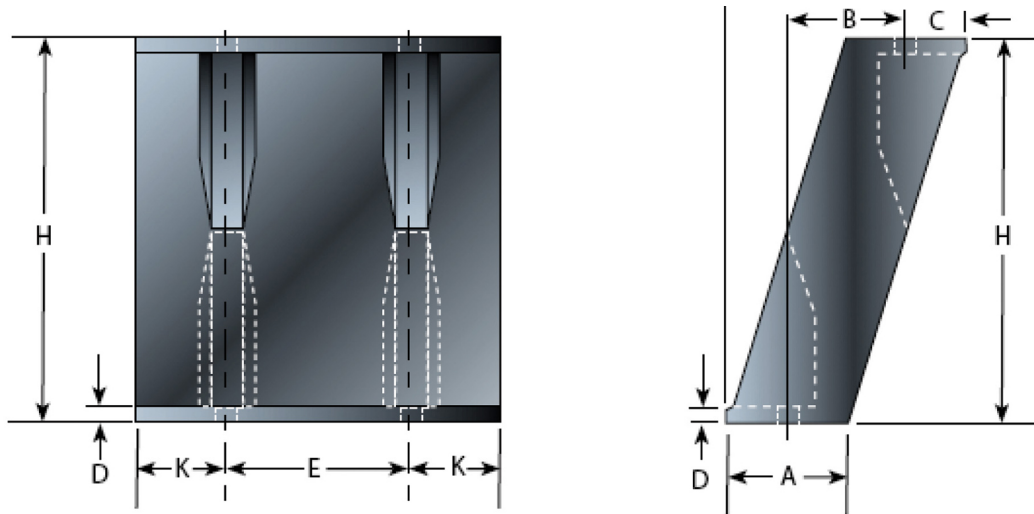

Model	H	A	B	C	W	D	K	E	Bolt Size
Metric	750	235	230	118	466	26	250	500	M36
Imperial	29.5	9.25	9.06	4.65	18.3	1.02	9.84	19.7	1-3/8

STANDARD RUBBER GRADE PERFORMANCE

EM-FG-750	G4		G3		G2		G1	
	R (kN)	E (kN-m)	R (kN)	E (kN-m)	R (kN)	E (kN-m)	R (kN)	E (kN-m)
Metric	401	138	341	117	281	96.8	221	76.2
Imperial	90.0	102	76.6	86.4	63.1	71.3	49.6	56.2

INTERMEDIATE RUBBER GRADES | Metric Units are in kN and kn-m Imperial units are in kips and ft-kips

Grade	Reaction/Energy	Metric	Imperial	Grade	Reaction/Energy	Metric	Imperial
G0.7	R	203	45.6	G2.4	R	305	68.6
	E	69.7	51.4		E	105	77.4
G0.8	R	209	47.0	G2.5	R	311	69.9
	E	71.8	52.9		E	107	78.9
G0.9	R	215	48.3	G2.6	R	71.3	71.3
	E	73.9	54.5		E	109	80.3
G1	R	221	49.7	G2.7	R	323	72.6
	E	76.0	56.0		E	111	81.8
G1.1	R	227	51.0	G2.8	R	329	74.0
	E	78.1	57.6		E	113	83.3
G1.2	R	233	52.4	G2.9	R	335	75.3
	E	80.2	59.1		E	115	84.8
G1.3	R	239	53.7	G3	R	341	76.7
	E	82.3	60.7		E	117	86.2
G1.4	R	245	55.1	G3.1	R	347	78.0
	E	84.4	62.2		E	119	87.8
G1.5	R	251	56.4	G3.2	R	353	79.4
	E	86.5	63.8		E	121	89.3
G1.6	R	257	57.8	G3.3	R	359	80.7
	E	88.6	65.3		E	123	9.09
G1.7	R	263	59.1	G3.4	R	365	82.1
	E	90.7	66.8		E	125	92.4
G1.8	R	269	60.5	G3.5	R	371	83.4
	E	92.8	68.4		E	128	94.0
G1.9	R	275	61.8	G3.6	R	377	84.8
	E	94.9	69.9		E	130	95.5
G2	R	281	63.2	G3.7	R	383	86.1
	E	97.0	71.5		E	132	97.1
G2.1	R	287	64.5	G3.8	R	389	87.5
	E	99.0	73.0		E	134	98.6
G2.2	R	293	65.9	G3.9	R	395	88.8
	E	101	74.4		E	136	100
G2.3	R	299	67.2	G4	R	401	90.2
	E	103	75.9		E	138	102

GENERALIZED PERFORMANCE CURVE-ELEMENT FENDER

— Reaction — — Energy

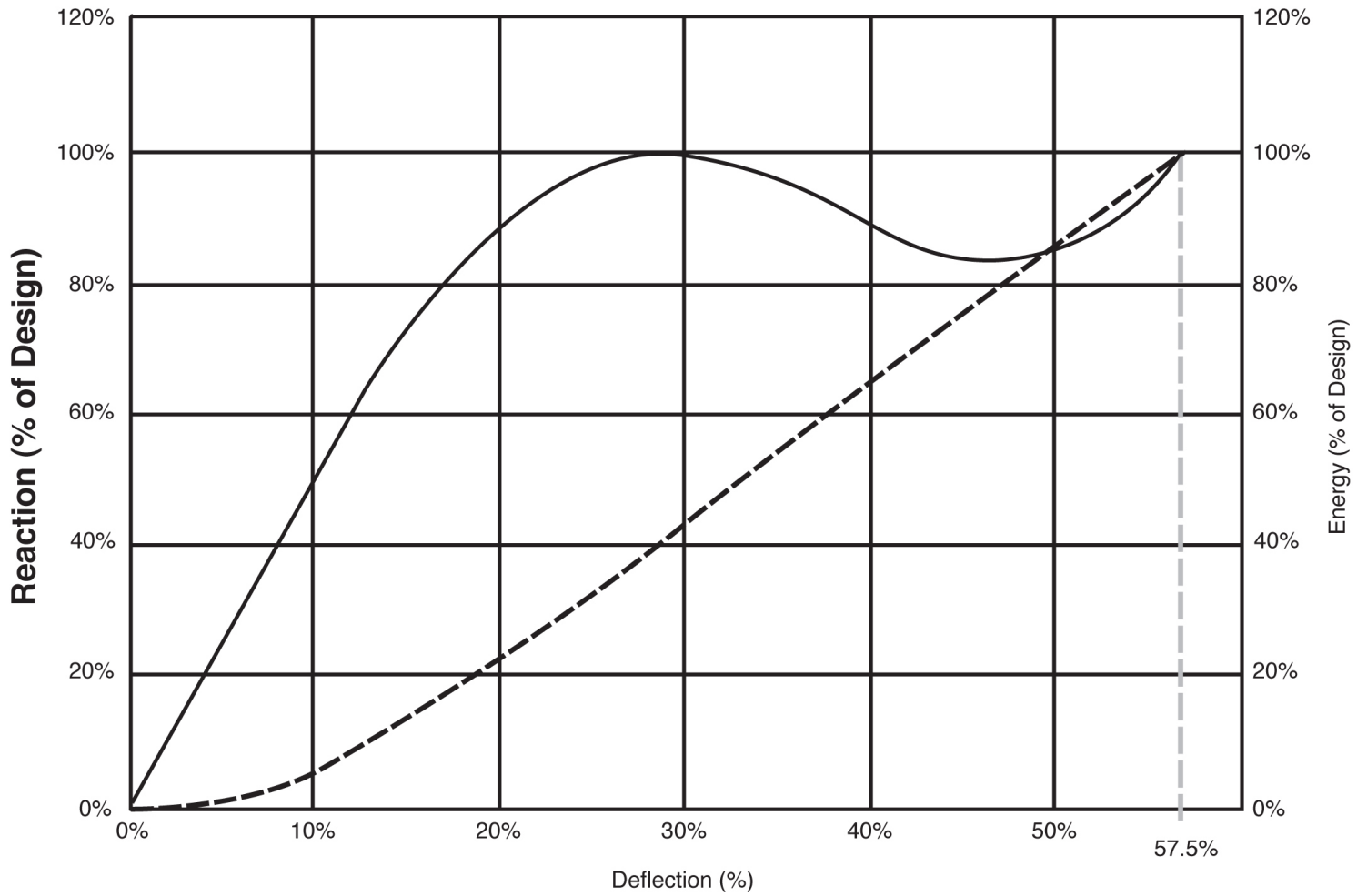

www.fendguard.com

Toll Free: 1-888-219-0418
Tel: (604) 273-4557

Fax: 1-888-845-9522 / (604) 273-1006
E-mail: sales@fendguard.com