

Element fenders are fully moulded rubber legs with embedded mounting plates. Fendguard's element type fenders are high performance units which are extremely compact and versatile. These fenders can also be used with a UHMW-PE shield to provide a low cost alternative to an arch type fender. The major characteristics of Fendguard's element type fender include:

- Good energy absorption to reaction force ratio (E/R)
- High energy absorption per weight of rubber
- A narrower footprint than traditional leg fenders which allows for a multitude of configurations
- Can be fixed behind a panel or a pile and can be provided in varying lengths
- Vertically and horizontally mounted elements may be combined in one system

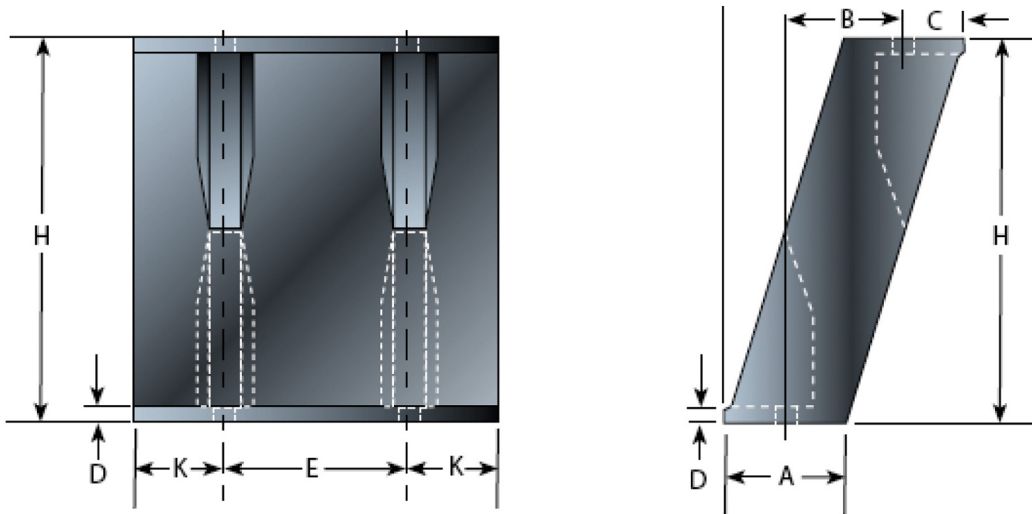

Model	H	A	B	C	W	D	K	E	Bolt Size
Metric	800	250	240	129	498	26	250	500	M36
Imperial	31.5	9.84	9.45	5.08	19.6	1.02	9.84	19.7	1-3/8

## STANDARD RUBBER GRADE PERFORMANCE

EM-FG-800	G4		G3		G2		G1	
	R (kN)	E (kN-m)	R (kN)	E (kN-m)	R (kN)	E (kN-m)	R (kN)	E (kN-m)
Metric	427	157	363	133	299	110	235	86.7
Imperial	96.0	116	81.7	98.3	67.3	81.1	52.9	63.9

## INTERMEDIATE RUBBER GRADES | Metric Units are in kN and kn-m Imperial units are in kips and ft-kips

Grade	Reaction/Energy	Metric	Imperial	Grade	Reaction/Energy	Metric	Imperial
G0.7	R	216	48.5	G2.4	R	325	73.0
	E	80.1	59.0		E	119	87.9
G0.8	R	222	50.0	G2.5	R	331	74.4
	E	82.4	60.7		E	122	89.5
G0.9	R	229	51.4	G2.6	R	75.9	75.9
	E	84.7	62.4		E	124	91.2
G1	R	235	52.8	G2.7	R	344	77.3
	E	87.0	64.1		E	126	92.9
G1.1	R	241	54.3	G2.8	R	350	78.7
	E	89.3	65.8		E	128	94.6
G1.2	R	248	55.7	G2.9	R	357	80.2
	E	91.6	67.5		E	131	96.3
G1.3	R	254	57.1	G3	R	363	81.6
	E	93.9	69.2		E	133	98.0
G1.4	R	261	58.6	G3.1	R	369	83.0
	E	96.2	70.9		E	135	99.8
G1.5	R	267	60.0	G3.2	R	376	84.5
	E	98.5	72.6		E	138	102
G1.6	R	273	61.5	G3.3	R	382	85.9
	E	101	74.3		E	140	103
G1.7	R	280	62.9	G3.4	R	389	87.4
	E	103	76.0		E	143	105
G1.8	R	286	64.3	G3.5	R	395	88.8
	E	105	77.7		E	145	107
G1.9	R	293	65.8	G3.6	R	401	90.2
	E	108	79.4		E	147	109
G2	R	299	67.2	G3.7	R	408	91.7
	E	110	81.1		E	150	110
G2.1	R	305	68.7	G3.8	R	414	93.1
	E	112	82.8		E	152	112
G2.2	R	312	70.1	G3.9	R	421	94.6
	E	115	84.5		E	155	114
G2.3	R	318	71.5	G4	R	427	96.0
	E	117	86.2		E	157	116

### GENERALIZED PERFORMANCE CURVE-ELEMENT FENDER

— Reaction — — Energy

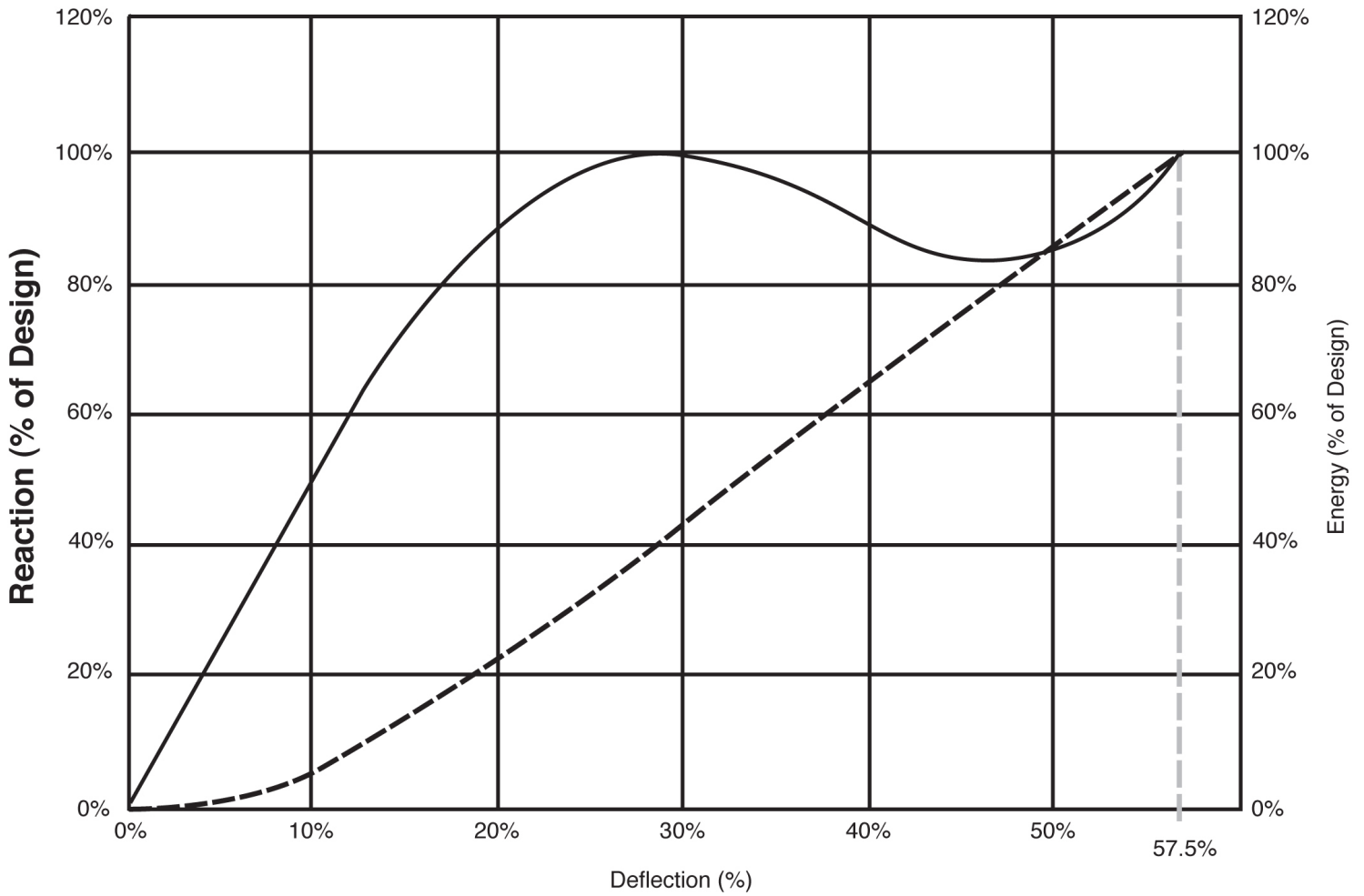

[www.fendguard.com](http://www.fendguard.com)

Toll Free: 1-888-219-0418  
Tel: (604) 273-4557

Fax: 1-888-845-9522 / (604) 273-1006  
E-mail: [sales@fendguard.com](mailto:sales@fendguard.com)