

Cone fenders are an improved version of Cell type Fender recently introduced and recommended for all type of applications including high tidal variation sites. Fendguard's cone type fender has the highest energy to reaction ratios of any fender currently in use. Its refined geometry and conical shape result in a number of outstanding performance characteristics which include:

- Exceptionally good energy absorption to reaction force ratio (E/R)
- High efficiency for designs to incorporate smaller, less costly cone fenders instead of larger, less efficient rubber body
- Deflection of 70% of its height and provides great flexibility in its application to operators
- High shear stability which allows the fender to carry even larger panel weights without using chains
- Very good inherent resistance against shear forces due to its geometry and self-centering characteristics
- Typically utilized with a complete fender panel system, but can also be used within a pile support system

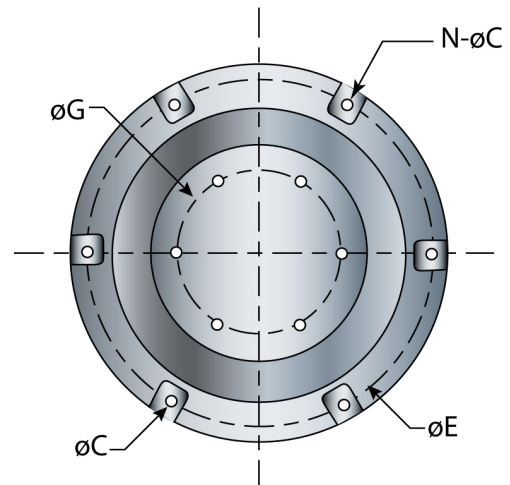
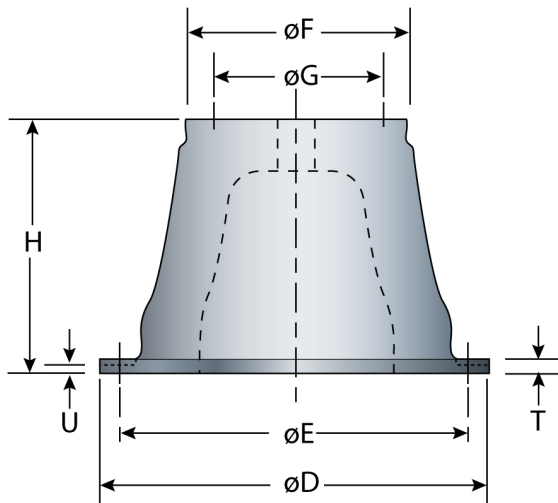

Model	H	ØD	ØE PCD	ØF	uG PCD	T	U	N - ØC	Bolt Size
Metric	600	900	810	510	390	27	22	6-30	M24
Imperial	23.6	35.4	31.9	20.1	15.4	1.06	0.87	6-1.18	M24

STANDARD RUBBER GRADE PERFORMANCE								
CN-FG-600	G4		G3		G2		G1	
	R (kN)	E (kN-m)	R (kN)	E (kN-m)	R (kN)	E (kN-m)	R (kN)	E (kN-m)
Metric	441	140	353	112	282	94.5	226	75.6
Imperial	99.2	104	79.4	83.0	63.5	69.7	50.8	55.8

INTERMEDIATE RUBBER GRADES Metric Units are in kN and kn-m Imperial units are in kips and ft-kips								
Grade	Reaction/Energy	Metric	Imperial		Grade	Reaction/Energy	Metric	Imperial
G0.7	R	209	47.0		G2.4	R	310	69.8
	E	70.6	52.1			E	101	74.6
G0.8	R	215	48.3		G2.5	R	318	71.4
	E	72.4	53.4			E	103	76.0
G0.9	R	220	49.5		G2.6	R	73.0	73.0
	E	74.2	54.7			E	105	77.3
G1	R	226	50.8		G2.7	R	332	74.6
	E	76.0	56.1			E	107	78.6
G1.1	R	232	52.1		G2.8	R	339	76.2
	E	77.8	57.4			E	108	80.0
G1.2	R	237	53.3		G2.9	R	346	77.8
	E	79.6	58.7			E	110	81.3
G1.3	R	243	54.6		G3	R	353	79.4
	E	81.4	60.0			E	112	82.6
G1.4	R	248	55.8		G3.1	R	362	81.3
	E	83.2	61.5			E	115	84.7
G1.5	R	254	57.1		G3.2	R	371	83.3
	E	85	62.7			E	118	86.7
G1.6	R	260	58.4		G3.3	R	379	85.3
	E	86.8	64.0			E	120	88.8
G1.7	R	265	59.6		G3.4	R	388	87.3
	E	88.6	65.3			E	123	90.9
G1.8	R	271	60.9		G3.5	R	397	89.2
	E	90.4	66.7			E	126	92.9
G1.9	R	276	62.1		G3.6	R	406	91.2
	E	92.2	68.0			E	129	95.0
G2	R	282	63.4		G3.7	R	415	93.2
	E	94	69.3			E	132	97.1
G2.1	R	289	65.0		G3.8	R	423	95.2
	E	95.8	70.7			E	134	99.1
G2.2	R	296	66.6		G3.9	R	432	97.2
	E	97.6	72.0			E	137	101
G2.3	R	303	68.2		G4	R	441	99.1
	E	99.4	73.3			E	140	103

GENERALIZED PERFORMANCE CURVE-CONE FENDER

— Reaction - - - Energy

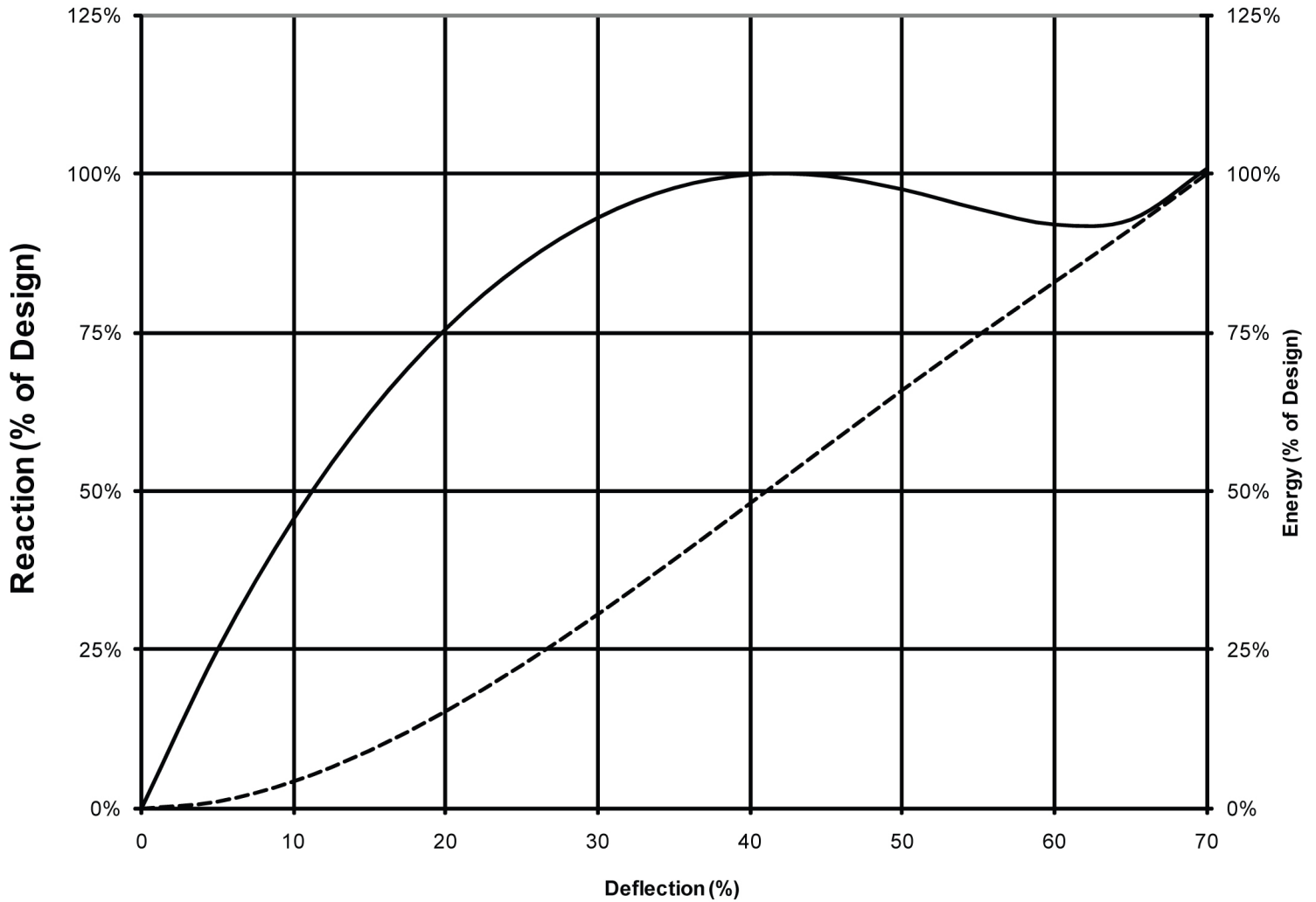

www.fendguard.com

Toll Free: 1-888-219-0418
Tel: (604) 273-4557

Fax: 1-888-845-9522 / (604) 273-1006
E-mail: sales@fendguard.com